

DO NOT SCALE FROM THIS DRAWING. ALL DIMENSIONS MUST BE CHECKED ON SITE. ANY DISCREPANCIES MUST BE REPORTED TO THE ARCHITECT / DESIGNER FOR VERIFICATION PRIOR TO COMMENCEMENT OF THE AFFECTED WORKS. THIS DRAWING IS COPYRIGHT.

| REV. | DATE | DESCRIPTION | BY |
|------|------|-------------|----|
| - | - | - | - |

GROSS INTERNAL FLOOR AREAS:

| | |
|--|----------------|
| EXISTING - (Sports Hall - 140sqm) | 410sqm |
| GROUND FLOOR - (New Sports Hall - 430sqm) | 850sqm |
| FIRST FLOOR - | 300sqm |
| TOTAL AREA - | 1150sqm |

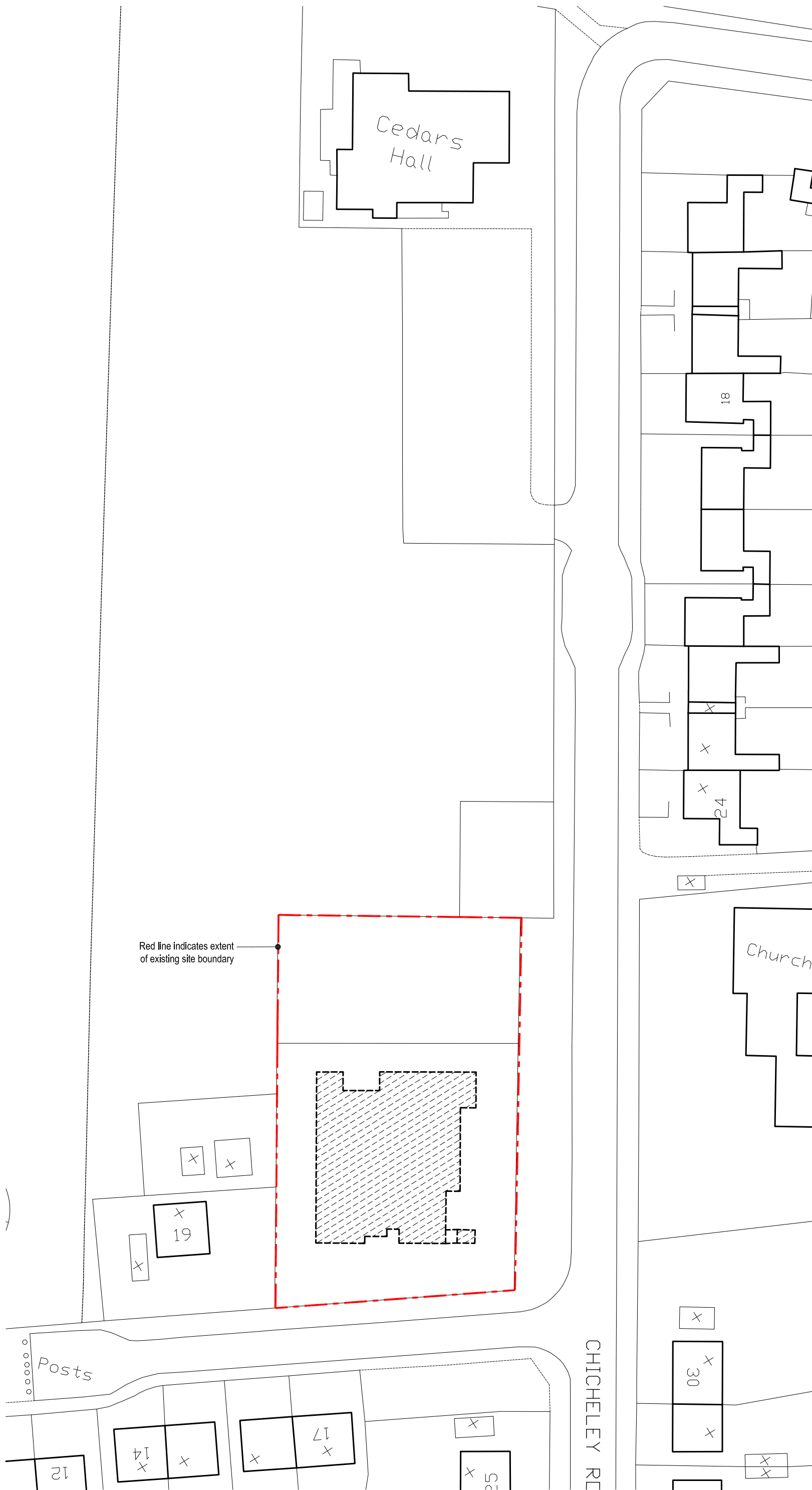

Red line indicates extent of existing site boundary



client
HARROW COUNCIL & WATFORD FOOTBALL CLUB

project
CEDARS YOUTH CENTRE REDEVELOPMENT

drawing title
EXISTING SITE PLAN

date
10.09.08 scale
1:500 @ A3

drawn by
TH checked by
RH

status
CONCEPT

drawing no.
673-00-ST-01 revision
-

LOM architecture and design
Boulevard House 92 Fortis Green London N2 9EY
T +44(0)20 8444 2999 F +44(0)20 8444 5999
W lom-fdp.com E mail@lom-fdp.com